

## Product Description

### WOOD DINING FURNITURE



### ITEM: WOOD DINING FURNITURE

**Customer Name:** XXXXXX & XXXxxx Ltd.

**Inspection Location:** Jiaozhou, Shandong, China

**Inspection Date:** 2010-12-7

**Reference Number:**

**P/O Number:** XX&XX-XX-NNNN

**Supplier:** QINGDAO XXXXXX XXXXXX XXXXX  
XXXXXXXX CO.,LTD

**Contact:** Xxx XXXXXX

**Order Quantity:**

XX-xxx: 600pcs, XX-xxx: 240pcs

XX-xxx: 40pcs, XX-xxx: 100pcs

**No. of Pieces ready for Inspection:**  
As order quantity

**Reference Sample Available:** NONE

Departure from Home/Office	Arrival Time at the factory	Departure from the Factory
7:30	9:00	16:30

Factory Cooperation during Inspection	AVERAGE
Factory Quality Organization	AVERAGE
Inspector's general opinion on the factory	AVERAGE

## IMPORTANT REMARKS

Check items:

### Products and package inspection:

Have audited 3 sets of product for each model and assembled 1 set for each model, per the packing list and assembly instruction, no components missed, all parts matches well; package is good, cartons sealed with tape.

### Loading Supervision

1. Container is 40Ht, brand new and clean, the finished quantity is correct according to the packing list.

2. The space of the container is limit, **not all the products were loaded in the container.**

XX-xxx: loaded 202pcs(PO Q'ty:240pcs), XX-xxx: loaded 39pcs(PO Q'ty: 40pcs)

XX-xxx: loaded 572pcs(PO Q'ty:600pcs), XX-xxx: loaded 99pcs(PO Q'ty:100pcs)





## INSPECTION STANDARDS

Inspection Type	Random Spot Check and Loading Supervision
Critical Defect	No
Major Defect	No

Minor Defect	No
--------------	----

Quality Criteria			
Seal/Container Numbers			
Comment	Type	Container No.	Shipping Co.'s Seal
	40HQ'	XXX NNNNNN NNXX	Xxxxxx XXX NNNNN

Quality Criteria			
Packing Slip			
Comment	Item#	Qty Expected	Qty Actual
	XX-xxx:	600	572
	XX-xxx:	240	202
	XX-xxx:	40	39
	XX-xxx:	100	99

PRODUCT			
			
	XX-xxx: chair-outer packing	XX-xxx: chair -marks	
			
	XX-xxx: chair-marks	XX-xxx: chair-inner packing	

Comment



XX-xxx: chair-parts



XX-xxx: chair



XX-xxx: chair -bolts



XX-xxx: chair hangtag-1



XX-xxx: chair hangtag-2



XX-xxx: chair-outer packing



XX-xxx: chair -mark1

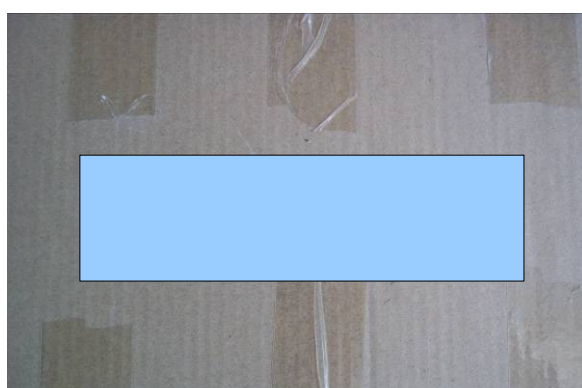

XX-xxx: chair -mark2





XX-xxx: chair –inner packing



XX-xxx: chair -parts



XX-xxx: chair

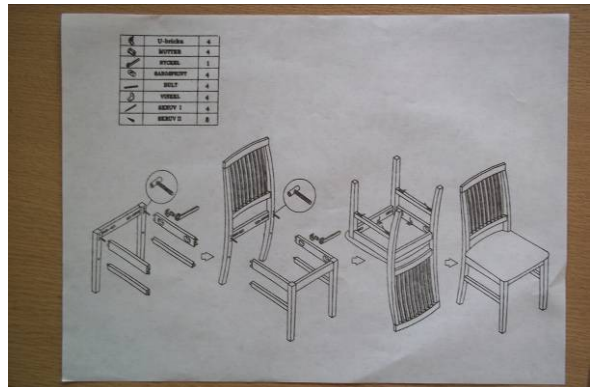

XX-xxx: chair –instruction sheet

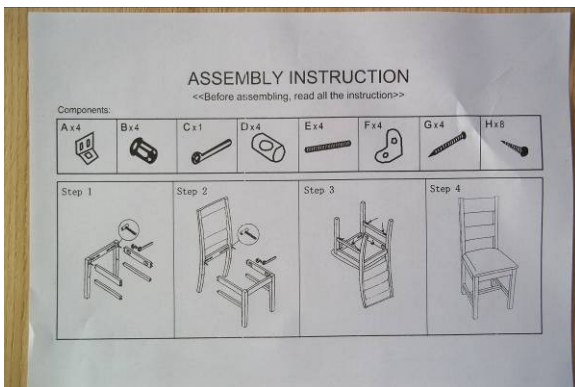

XX-xxx: chair –instruction sheet



XX-xxx: table-outer packing



XX-xxx: table-inner packing

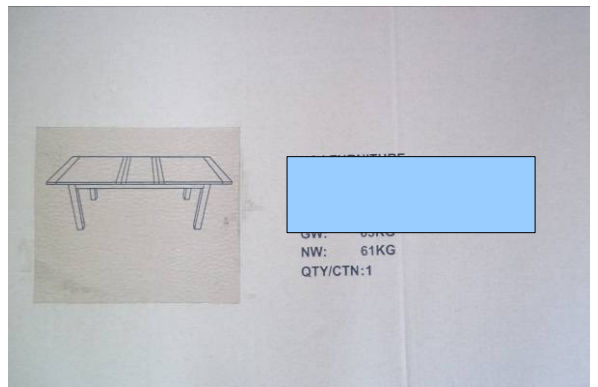

XX-xxx: table mark1



XX-xxx: table mark2

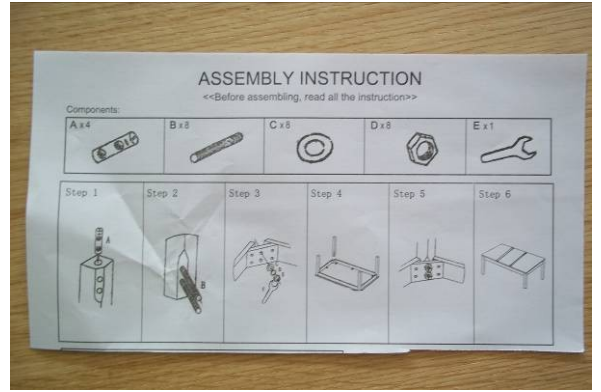

XX-xxx: table instruction sheet



XX-xxx: table



XX-xxx: table-outer packing



XX-xxx: table-inner packing

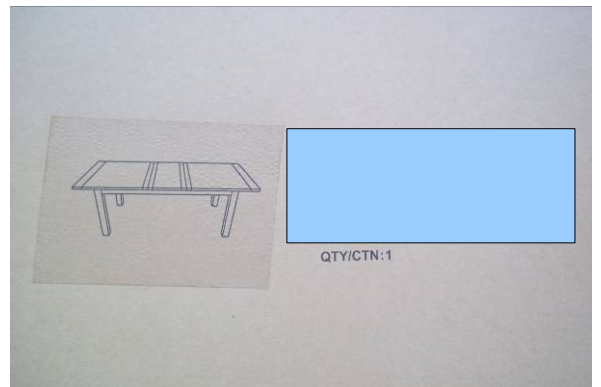

XX-xxx: table mark1



XX-xxx: table mark2

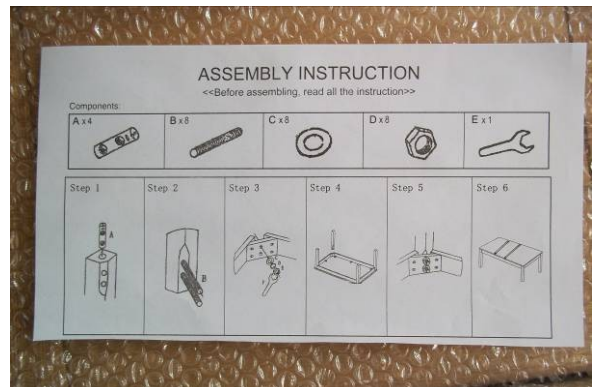

XX-xxx: table instruction sheet





XX-xxx: table



XX-xxx: table bolts



Container side

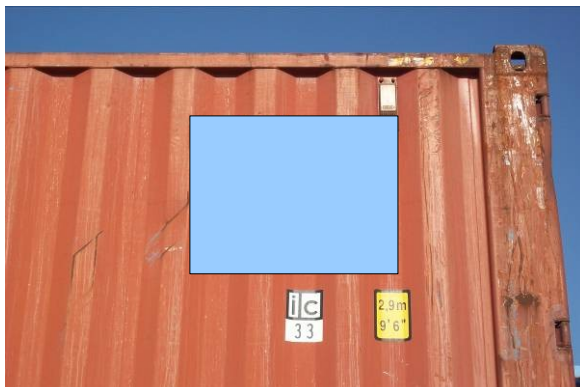

Container number



Empty Container



Loading



Loading-1



Loading-2



Loading-3



Loading-4



Loading-5



Loading-6



Loading-7



Loading-8



Loading-9



Loading-10





Full



Close right door



Close all doors



Seal

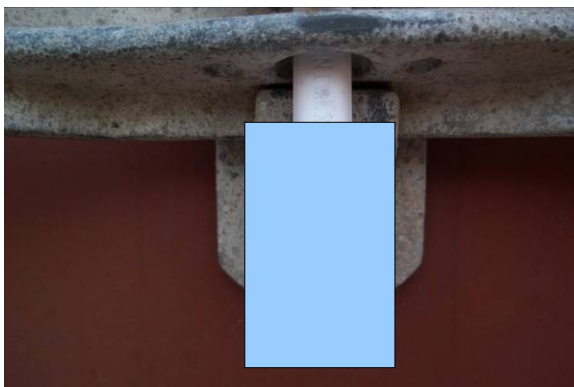

Seal number

**Please visit your online account to view larger pictures**

**END OF REPORT**